

STANFORD COURT
3001 Wilshire Blvd.
Santa Monica, CA 90403

Restaurant Space for Lease

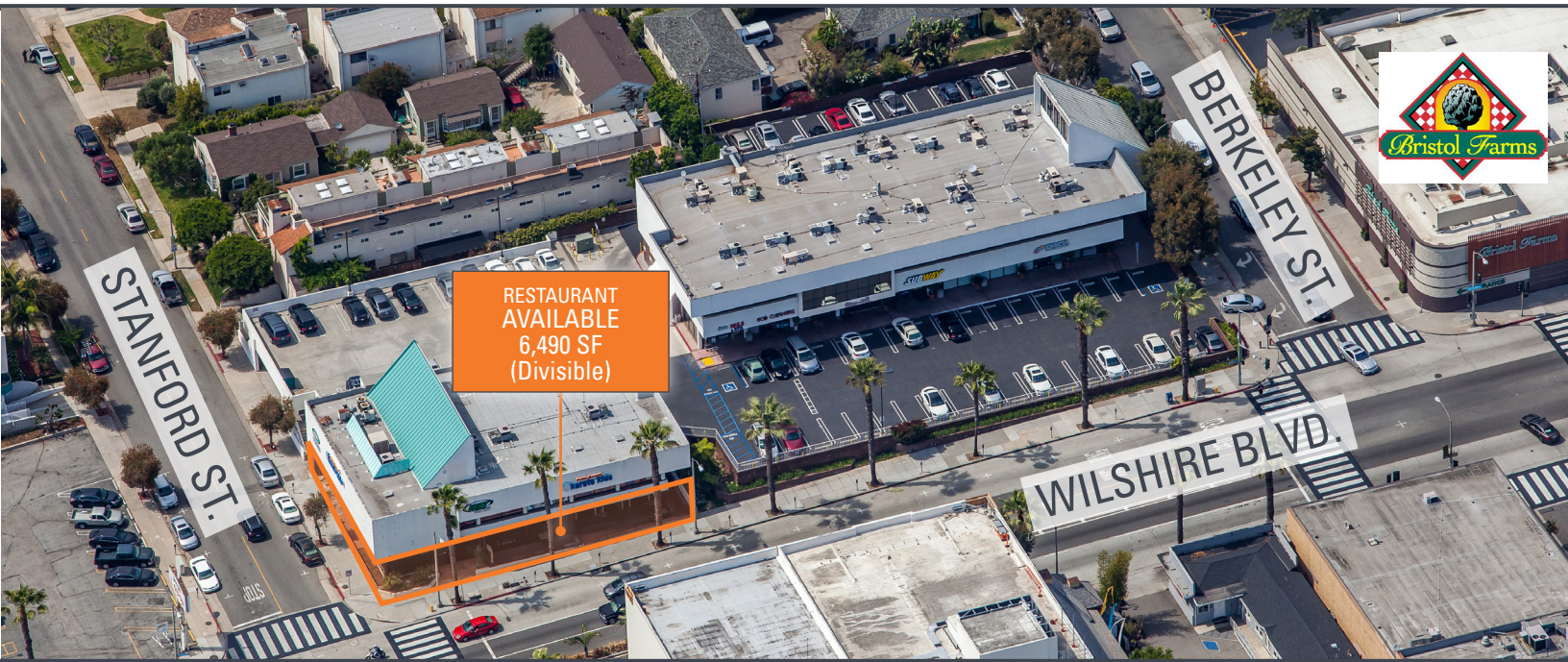

JOIN NEIGHBORING TENANTS



PROPERTY DESCRIPTION

Location: **3001 Wilshire Blvd.,
Santa Monica, CA 90403**

Available Space: **±6,490 SF (Divisible)**

Rent: **\$6.00 PSF/Month, NNN**

Parking: **Abundant**

PROPERTY HIGHLIGHTS

- Highly visible corner in the heart of Santa Monica
- Excellent signage opportunity
- 2nd generation restaurant space
- Adjacent to new Bristol Farms
- Strong demographics
- 37,000 cars per day at Wilshire Blvd. and Centinela Ave.

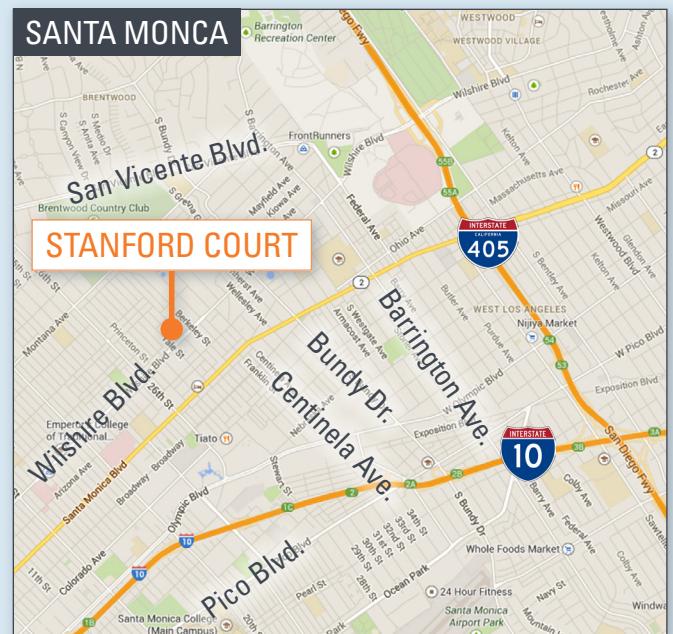

ED SACHSE
Executive Managing Director
Kennedy Wilson Brokerage Group
tel: 310-887-6250
email: esachse@kennedywilson.com
CalBRE #01021349

CHRISTINE DESCHAINE
Senior Vice President
Kennedy Wilson Brokerage Group
tel: 310-887-6440
email: cdeschaine@kennedywilson.com
CalBRE #00905121

KENNEDY WILSON

thriving on opportunity[®]

STANFORD COURT
3001 Wilshire Blvd.
Santa Monica, CA 90403

Restaurant Space for Lease



Street View from Wilshire Blvd.



Aerial View

ED SACHSE
Executive Managing Director
Kennedy Wilson Brokerage Group
tel: 310-887-6250
email: esachse@kennedywilson.com
CalBRE #01021349

CHRISTINE DESCHAINE
Senior Vice President
Kennedy Wilson Brokerage Group
tel: 310-887-6440
email: cdeschaine@kennedywilson.com
CalBRE #00905121

KENNEDY WILSON

thriving on opportunity[®]

SITE PLAN

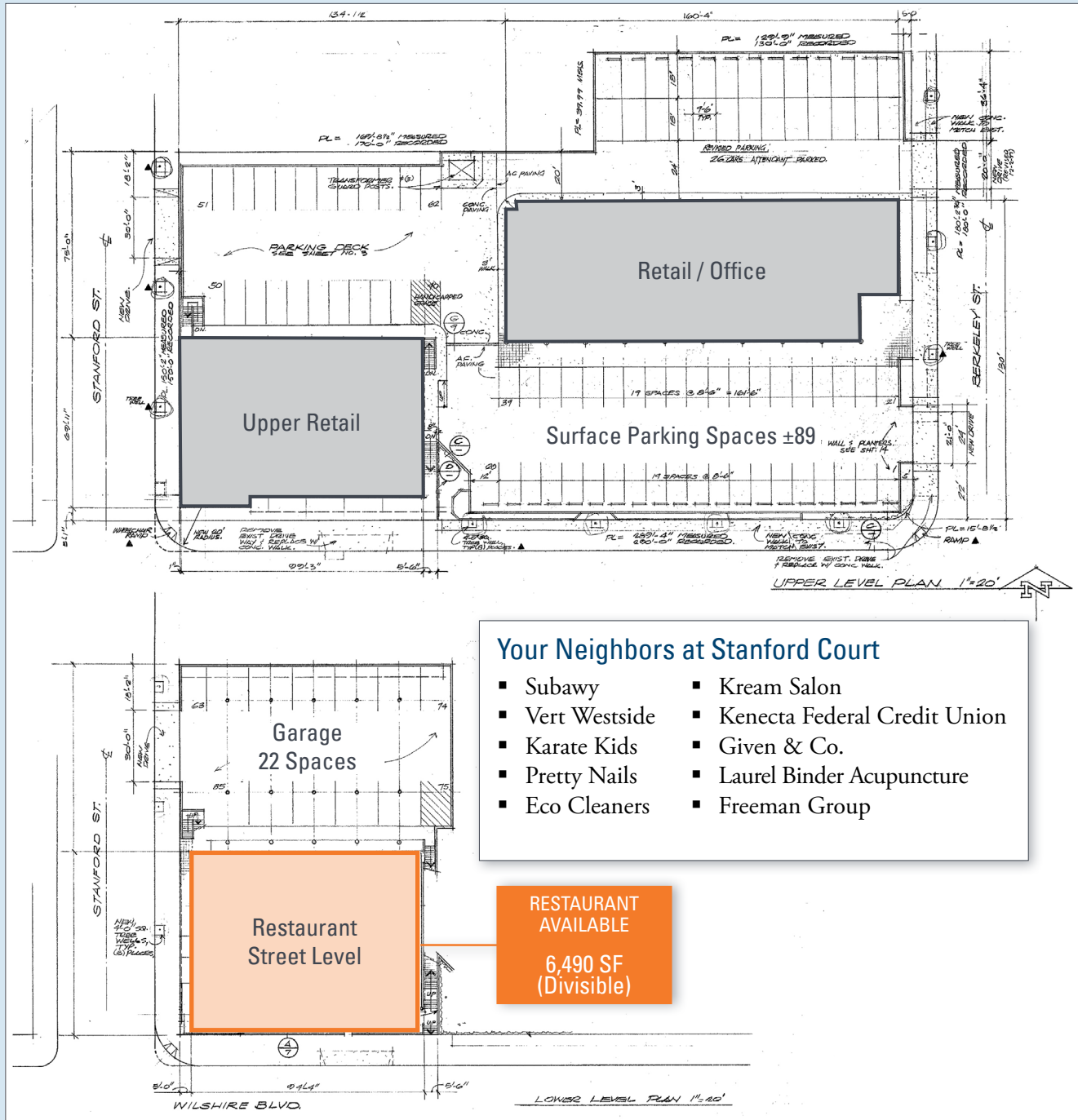

Your Neighbors at Stanford Court

- Subway
- Vert Westside
- Karate Kids
- Pretty Nails
- Eco Cleaners
- Kream Salon
- Kenecta Federal Credit Union
- Given & Co.
- Laurel Binder Acupuncture
- Freeman Group

RESTAURANT AVAILABLE
6,490 SF (Divisible)

ED SACHSE
 Executive Managing Director
 Kennedy Wilson Brokerage Group
 tel: 310-887-6250
 email: esachse@kennedywilson.com
 CalBRE #01021349

CHRISTINE DESCHAIINE
 Senior Vice President
 Kennedy Wilson Brokerage Group
 tel: 310-887-6440
 email: cdeschaine@kennedywilson.com
 CalBRE #00905121



thriving on opportunity®

STANFORD COURT
 3001 Wilshire Blvd.
 Santa Monica, CA 90403

Restaurant Space for Lease

TRADE AREA



DEMOGRAPHICS	1 MILE	3 MILES	5 MILES
2010 Estimated Population	41,563	127,902	250,054
2013 Estimated Average HH Income	\$111,199	\$113,512	\$122,650
2013 Estimated Total Employees	41,196	126,620	260,023

ED SACHSE
 Executive Managing Director
 Kennedy Wilson Brokerage Group
 tel: 310-887-6250
 email: esachse@kennedywilson.com
 CalBRE #01021349

CHRISTINE DESCHAINE
 Senior Vice President
 Kennedy Wilson Brokerage Group
 tel: 310-887-6440
 email: cdeschaine@kennedywilson.com
 CalBRE #00905121



thriving on opportunity®